

RX20 功率型被釉线绕电阻器 2.5W-300W

Power Power Vitrified Wire Wound Resistors 2.5W-300W

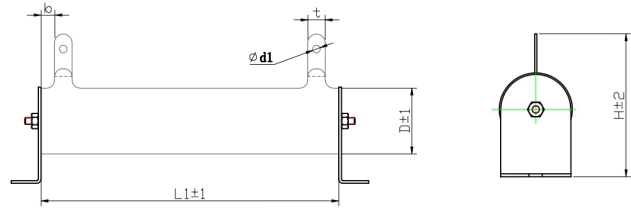

产品特点 Features

- 高温负荷特性
Excellent high temperature load performance
- 耐潮湿、耐腐蚀，可在恶劣环境中使用
Moisture resistance
- 高过载能力
High over loading ability
- T 系列为可调
T series is adjustable

应用范围 Applications

- 电力分配，负荷测试
Electric power distribution, load test
- 适用于功率电源
Applied for functional power supply
- 变频电源等领域
Variable frequency power source etc
- 用于工控的伺服系统中软启动和制动部分
Applied to the soft starting and breaking parts of industrial controlled servo drive system

主要性能技术指标 Main specification

型号 Type	功率 Power (W)	阻值范围 Resistance Range	阻值精度 Tolerances Range	温度系数 T.C.R (10-6/°C)	外形尺寸 Dimensions (mm)								
					L	D	d	H	L1	K	b	t	d1
RX20	2.5	5.1-430R	± 5% (J) ± 10% (K)	± 250	26 ± 1.5	13 ± 2	4.0 ± 0.5	27 ± 2.5	-	-	3.5 ± 0.8	4.5	2
	8	5.1-3.3K			36 ± 1.5	14 ± 2	5.5 ± 0.5	28.5 ± 2.5	-	-	3.5 ± 0.8	4.5	2
	10	5.1-10K			41 ± 1.5	14 ± 2	5.5 ± 0.5	28.5 ± 2.5	20	6 ± 2	3.5 ± 0.8	4.5	2
	15	5.1-15K			45 ± 1.5	17 ± 2	8.0 ± 0.5	31 ± 2.5	23	6 ± 2	3.5 ± 0.8	4.5	2
	20	5.1-20K			51 ± 2	17 ± 2	8.0 ± 0.5	31 ± 2.5	30	6 ± 2	3.5 ± 0.8	4.5	2
	25	10-24K			51 ± 2	21 ± 2.5	12 ± 0.6	35 ± 2.5	30	6 ± 2	3.5 ± 0.8	4.5	2
	30	10-30K			71 ± 2.2	21 ± 2.5	12 ± 0.6	35 ± 2.5	44	6 ± 2	3.5 ± 0.8	4.5	2
	40	20-40K			87 ± 2.2	21 ± 2.5	12 ± 0.6	35 ± 2.5	57	6 ± 2	3.5 ± 0.8	6	2
	50	20-51K			91 ± 2.4	29 ± 3	20 ± 1.1	43 ± 2.5	60	7 ± 2	4.5 ± 1	6	2
	75	24-62K			140 ± 3.2	29 ± 3	20 ± 1.1	43 ± 2.5	110	7 ± 2	4.5 ± 1	6	2.5
	100	24-62K			170 ± 3.5	29 ± 3	20 ± 1.1	43 ± 2.5	140	7 ± 2	4.5 ± 1	6	2.5
	150	20-62K			215 ± 4	29 ± 3	20 ± 1.1	43 ± 2.5	185	7 ± 2	4.5 ± 1	6	2.5
	200	20-62K			270 ± 4	29 ± 3	20 ± 1.1	43 ± 2.5	210	7 ± 2	4.5 ± 1	6	2.5
	300	20-3K			280 ± 4	37 ± 3	16 ± 1.1	46 ± 3	210	7 ± 2	4.5 ± 1	10	4.5

订货示例 How to order

产品型号 Type	功率 Power	标称阻值 Nominal value	精度 Tolerance
RX20	80W	51R	± 5%